



## 7 Monmouth Road

Watford, WD17 1QW

**£1,750 Per Month**

This well-presented two-bedroom ground floor flat is available to rent at £1,750 per month from 1st June, offering a spacious and practical layout ideal for professionals, couples, or small families.

The property features a bright and generous open-plan kitchen and living area, perfect for both everyday living and entertaining. There are two well-proportioned double bedrooms, including a primary bedroom with en-suite, alongside a separate modern bathroom.

Additional benefits include a private garden and off-street parking for added convenience. Early viewing is highly recommended.

### Viewing

Please contact our Watford Office on 01923224030 if you wish to arrange a viewing appointment for this property or require further information.

- Two-bedroom ground floor flat
- Available from 1st June
- Spacious open-plan kitchen/living area
- En-suite to primary bedroom
- Private garden
- Off-street parking
- EPC Rating C
- Council Tax Band D
- Holding Deposit £403



## Floor Plan

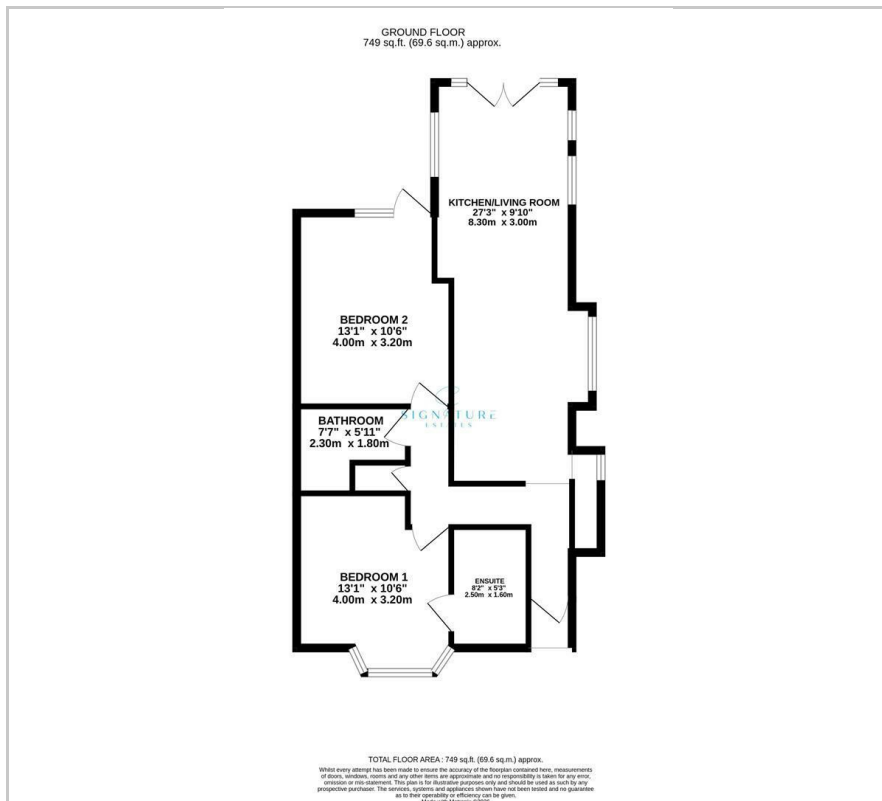

## Area Map



## Energy Efficiency Graph

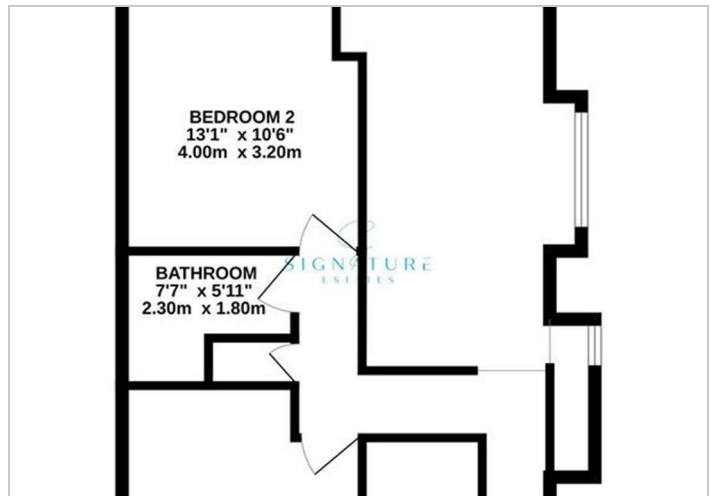
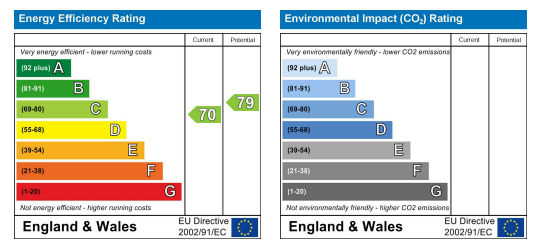

These particulars, whilst believed to be accurate are set out as a general outline only for guidance and do not constitute any part of an offer or contract. Intending purchasers should not rely on them as statements of representation of fact, but must satisfy themselves by inspection or otherwise as to their accuracy. No person in this firm's employment has the authority to make or give any representation or warranty in respect of the property.